

LEAD-LINED

GENERATOR AND STORAGE CABINET

The Generator and Storage Cabinet provides hot lab radiation protection without hampering the elution process. The left drawer accommodates top or side loading generators. In addition to the .5" or 1" lead shielding in front, the drawer has .25" lead shielding on the remaining three sides and bottom. A removable drawer top allows generator replacement. Trap doors on the top and sides of this drawer provide safe access to the generator. The cabinet has two shielded compartments on the right side for storing decaying generators prior to disposal.

SPECIFICATIONS:

Dimensions: 36.5" w x 24" d x 36.5" h (92.7 x 61 x 92.7 cm)

Lead Shielding:

Cabinet: .5" (1.3 cm) or 1" (2.5 cm) thick on all six sides

Drawer: .25" thick (.64 cm) on five sides

Dividers: .5" thick (1.3 cm)

Drawer Dimensions: I.D.: 15.5" w x 11.9" depth x 18.2" h
(39.4 x 30.2 x 46.2 cm)

Doors and Drawer: Key-locked

Countertop: Stainless steel with 4" backsplash and .5" spill-proof lip

Finish: Durable powder-coat paint

Weight:

244-181: 1631 lb (740 kg)

244-182: 2783 lb (1262 kg)



244-181 Cabinet, Generator and Storage,
.5" lead\$16,400.00

244-182 Cabinet, Generator and Storage,
1" lead 20,000.00

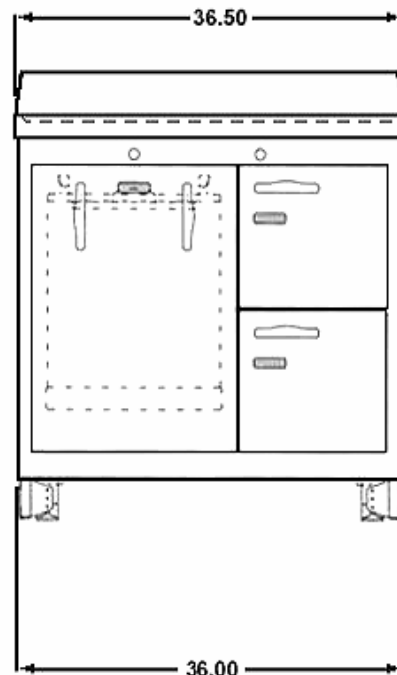
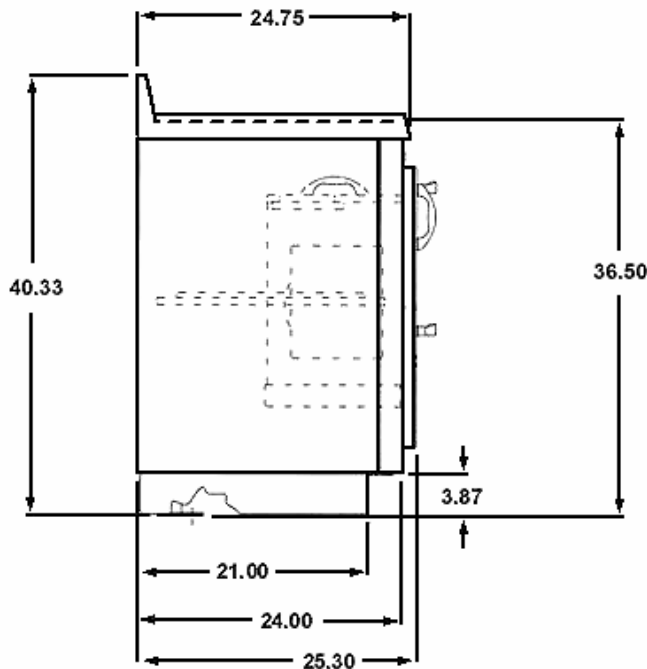

Prices subject to change without notice.

www.jgravengard.com 2007-10-12

J. Gravengard Corporation

Medical Imaging Sales & Service

PO Box 20171 Portland, Oregon 97294 Nationwide (800)796-SCAN Local (503)255-0535 Fax (503)255-7047